



**WACKER
NEUSON**
all it takes!

ET35

Tracked Conventional Excavator

Impressive productivity

The tracked excavator in the 3.5-metric ton class impresses with its performance and many well thought-out details. Along with the optimized engine-pump management for up to 15% faster working cycles, the excellent stability and the ergonomically designed cabin ensure efficient and fatigue-free work. Thanks to the numerous options available ex work, the ET35 can also be adapted individually to the customer's requirements.

Highlights

- VDS Vertical Digging System
- Optimized drive concept
- Jog dial
- Comfortable, fully glazed cab
- Up to four additional factory-installed control circuits

Technical Data

Hydraulic

| | |
|-------------------------------|-------------------------------|
| Operating pressure hydraulics | 240.0 bar |
| Hydraulic pump | Axial piston and 2 gear pumps |
| Flow rate max. | 120.0 l/min |

Mechanical - Output Details

| | |
|------------------------|---------------|
| Nominal rotation speed | 2,400.0 1/min |
| Travel speed | 4.7 km/h |

Mechanical Details

| | |
|------------------------------|----------------------|
| Length | 5,271.0 mm |
| Width | 1,630.0 mm |
| Height | 2,711.0 mm |
| Operating weight (min.-max.) | 3,553.0 - 4,753.0 kg |
| Digging depth (max.) | 3,497.0 mm |

Engine

| | |
|-------------------|-------------------------|
| Cooling | Water-cooling |
| Engine type | Diesel engine |
| Cylinder | 3.0 |
| Cylinder capacity | 1,642.0 cm ³ |

| | |
|-------------------------------|---------------|
| Inclined position max. | 30.0 ° |
| Fuel | Diesel EN 590 |
| Effective power | 18.2 KW |
| Nominal Engine speed | 2,400.0 1/min |
| Exhaust-gas limit | EU Stage V |
| Battery capacity (nom. value) | 71.0 Ah |
| Engine Manufacturer | Yanmar |
| Engine Designation | 3TNV88 |

Environment Data

| | |
|-----------------------------|------------|
| Sound power LWA, guaranteed | 94.0 dB(A) |
|-----------------------------|------------|

Operating Fluids

| | |
|------------------------|---------|
| Oil volume | 6.700 l |
| Cooling fluid volume | 5.0 l |
| Hydraulic fluid volume | 61.5 l |

Chassis

| | |
|----------------|-----------------------------|
| Traction drive | Axial piston motor with RGU |
|----------------|-----------------------------|

Shipping and Storage

| | |
|-----------------|------------|
| Shipping weight | 3,364.0 kg |
|-----------------|------------|

Dimensions

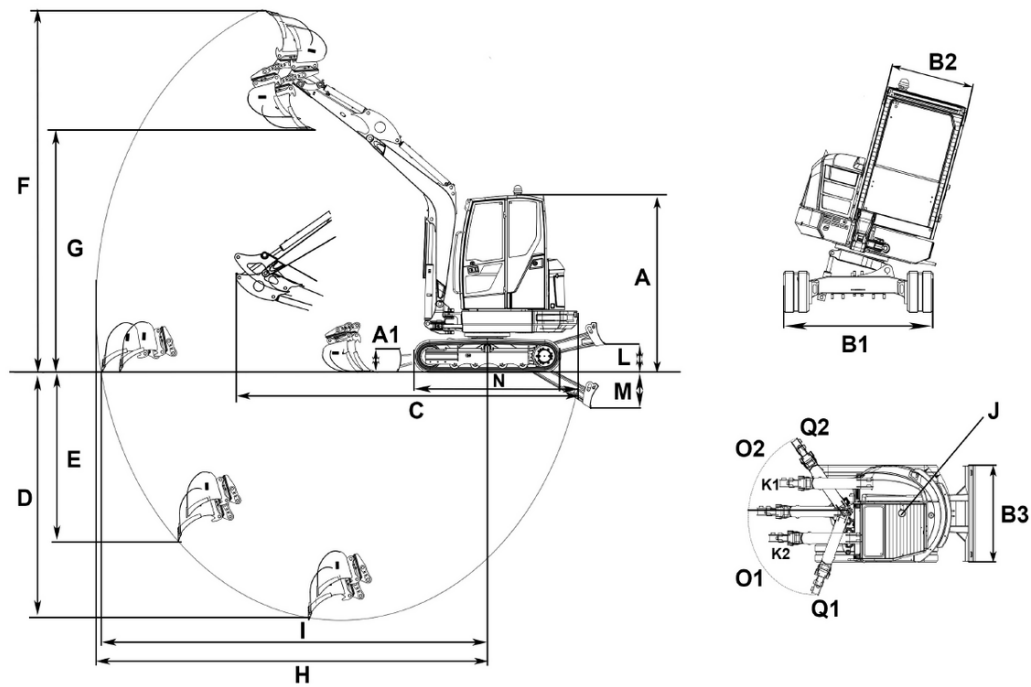

| | | |
|----|---|----------|
| A | Height with cab | 2,491 mm |
| | Total height with rotating beacon | 2,630 mm |
| B1 | Width of cab | 980 mm |
| B2 | Width travel gear | 1,630 mm |
| B3 | Width of dozer blade | 1,630 mm |
| C | Transport length short shovel arm | 5,268 mm |
| D | Digging depth max., short shovel arm | 3,245 mm |
| | Digging depth max., long shovel arm | 3,497 mm |
| E | Piercing depth max., short shovel arm | 2,120 mm |
| | Piercing depth max., long shovel arm | 2,360 mm |
| F | Piercing height max., short shovel arm | 4,929 mm |
| | Piercing height max., long shovel arm | 5,082 mm |
| G | Dumping height max., short shovel arm | 3,337 mm |
| | Dumping height max., long shovel arm | 3,489 mm |
| H | Digging radius max., short shovel arm | 5,270 mm |
| | Digging radius max., long shovel arm | 5,507 mm |
| I | Max. reach at ground level (short shovel arm) | 5,158 mm |
| | Max. reach at ground level (long shovel arm) | 5,408 mm |
| J | Tail swing radius | 1,168 mm |
| K1 | Boom offset max. (to center of bucket right side) | 476 mm |
| K2 | Boom offset max. (to center of bucket left side) | 447 mm |
| L | Stacking height max. (dozer blade above surface) | 393 mm |
| M | Digging depth max. (dozer blade below surface) | 505 mm |
| N | Length travel drive | 2,062 mm |
| O1 | Max. swivel angle (arm system to the left) | 70 ° |
| O2 | Max. swivel angle (arm system to the right) | 55 ° |
| Q1 | Boom swing radius right | 55 ° |
| Q2 | Boom swing radius left | 70 ° |